

DIGISOL[®]

**INDIA'S OWN
IT NETWORKING
CHOICE**

Quick Installation Guide

8 Port 10/100/1000Mbps Gigabit Ethernet Desktop Unmanaged Switch

DG-GS1008DGE



V1.1
26-09-2025

Copyright

Copyright 2025 by DIGISOL SYSTEMS LTD. All rights reserved.
Company has an on-going policy of upgrading its products and it may be possible that information in this document is not up-to-date.
Please check with your local distributors for the latest information.
No part of this document can be copied or reproduced in any form without written consent from the company.

Trademarks:

DIGISOL® is a trademark of DIGISOL SYSTEMS LTD. All other trademarks are the property of the respective manufacturers.

Package Contents :

The following items should be present in your package:

- Switch 8 port 10/100/1000 Mbps (1 No)
- Power Adapter 5V DC/1A. (1 No)
- Quick installation guide

Make sure that the package contains above items.

Product Overview :

Accelerate the performance of your local wired network with the 8-Port Business Desktop Gigabit Switch. It is offering eight gigabit Ethernet auto-sensing ports with wired connection speeds of up to 1,000 Mbps, this unmanaged switch lets your home or office to expand its local network and send large files to servers, drives, and printers at gigabit speed. With plug-and-play convenience and auto-sensing ports that automatically optimize speed for each connected device, offers a quick and easy solution for extending your office or home network.

Precautions :

- Do not install the equipment in direct sunlight or near any equipment that generates high amount of heat
- Do not install the equipment in damp, dusty or sooty places
- Always keep the equipment installed horizontally, or on a stable platform to prevent the product from falling
- Do not drop or spill liquids on the equipment and ensure that liquid-filled items are not spilled on the equipment
- Prevent any sort of liquid from flowing into equipment
- Install the switch in a well-ventilated place. Do not block the ventilation vent of the equipment
- Equipment can only be used within the permissible input and output range
- Do not disassemble the equipment by your own self
- Maintain the range of humidity while storing or during transportation

Disclaimer :

Instructions and procedures will be updated consistently according to the product upgradation without subject to any prior notice. If any of the instructions mentioned in the guide are not followed by the user, the loss will be borne by the user. Instructions may contain technical inaccuracies or inconsistencies with product functions and operations, or printing errors, in accordance with the company's final interpretation.

Typical Application :

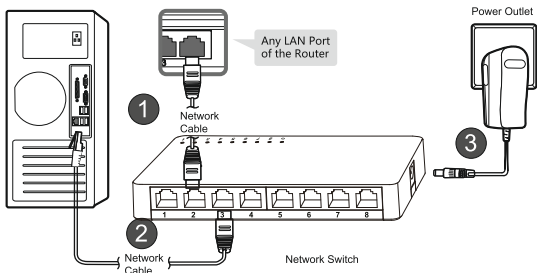

Device Connection Diagram

(The picture is for reference only, please refer to the actual product)

Product Characteristics :

- Supports 8*1000 Mbps Ports.
- The switching capacity is 16Gbps Full duplex.
- MAC automatic learning and aging, the capacity of MAC address list is 8K.
- All ports support MDI/MDIX.
- Support AC 100-240V, 50/60Hz input power Adapter .

Environmental Specifications :

- Operating Temperature: 0°C~40°C
- Storage Temperature: -20°C~70°C
- Operating Humidity: 10%~90% non-condensing.
- Storage Humidity: 5%~90% non-condensing

LED Description :

LED	NAME	STATUS	DESCRIPTION
Power	Power Indicator	Always On	Already Power On
1-8 Ports	Port Indicator	Always On	Port Connected Normally
		Flashing	Port is Transmitting Data

Installation :

Precautions for Installation

- Do not install the device in an unstable location such as on an unsteady table or an inclined surface.
- Do not place another hub or object that generates heat on this unit.
- Please route all cables properly to prevent people from tripping over them.
- Ensure the air vents on the product are not blocked by other equipment or walls.
- Only use the power Adapter included with the product.

Mounting to a Wall

To mount the unit directly to the wall, use 2 screws (not included) . Install the screws apart and slide the mounting holes on the base of the switch over them.

Install on the Desk

Put on the Desk, connect with the Network Cable and the power adapter

DIGISOL[®]

WARRANTY

This Product is covered under DIGISOL Warranty program backed by DIGISOL Service Center. To avail this Warranty offer, customer needs to contact DIGISOL's Technical Assistance Center for the same. You may be asked to provide proof of purchase of product for warranty claim of defective product. Please refer website www.digisol.com for the detailed support terms & conditions and support process.

Warranty Policy

1. **Hardware Warranty :** Hardware warranty period shall be limited up to Three years. External Power Adapter shall carry One year warranty only against manufacturing defects. Any repair or replacement will be rendered by DIGISOL at its Service Center only.
2. **Software Warranty :** DIGISOL issues this Limited Software Warranty that the software portion of the product ("Software") will substantially conform to DIGISOL's then current functional specifications for the software, as set forth in the applicable documentation, from the date of original retail purchase of the Software for a period of one year ("Software Warranty period"), provided that the Software is properly installed on approved hardware and operated as contemplated in its documentation.
3. **Governing Law:** This warranty shall be governed by Indian Laws.
4. **Warranty shall subject to the terms & conditions specified in the DIGISOL Product Warranty policy displayed on www.digisol.com**
5. **To avail and activate warranty for your product.**
Kindly register your product by calling us @1800 209 3444

DIGICARE



helpdesk@digisol.com



1800 209 3444





DIGISOL SYSTEMS LIMITED

L-7, Verna Industrial Estate,
Salcete, GOA - 403722

www.digisol.com

DIGICARE

☎ **1800 209 3444**

✉ helpdesk@digisol.com